

T30



trend[®]
routing technology

Dear Customer

Thank you for purchasing this Trend product, we hope you enjoy many years of creative and productive use.

Please remember to return your guarantee card within 28 days of purchase.

CONTENTS

TECHNICAL DATA _____	1
SAFETY _____	2-3
ELECTRICAL SAFETY _____	4
VACUUM CLEANING SAFETY _____	5
MANUFACTURERS DECLARATION _____	6
ITEMS ENCLOSED _____	6
DESCRIPTION OF PARTS _____	7
ASSEMBLY _____	8
OPERATION	
- Suction of Dry Dust and Dirt _____	9
- Suction of Fluids _____	10
MAINTENANCE _____	10
ENVIRONMENTAL PROTECTION _____	10
GUARANTEE _____	10
ACCESSORIES _____	12
SPARE PARTS	
- Spare Parts List _____	11-12
- Spare Parts Diagram _____	IB

TECHNICAL DATA

Voltage:	UK & Eire	230V
	UK & Eire	110V
	Europe	230V
Ampage:	230V	5.2A
	110V	10A
Power input		1200W
Autostart:	230V	max 2000 watts min 40 watts
	110V	max 1000 watts min 40 watts
Airflow		3,300 l/min
Max vacuum		2300mm H2O
Noise		72 dB
Hose		5M x 36mm OD
Container volume:	dry	34L
	wet	25L
Dimensions		620 x 400 x 400mm
Weight		11.5kg
Fuse:	UK & Eire	230V 13A in plug
	UK & Eire	110V 16A in mains
	Europe	230V 10A in mains

The following symbols are used throughout this manual:



Denotes risk of personal injury, loss of life or damage to the tool in case of non-observance of the instructions in this manual.



Denotes risk of electric shock.

Ensure when using the autostart function that the power tool to be connected to the autostart is in compliance with 2006/42/EC (identified by the CE marking on the power tool).

INTENDED USE

The extraction is intended to vacuum dry dust and dirt when suitable filters are fitted. It can also vacuum fluids when filters are removed. It must not be used to vacuum hazardous substances.



If you require further safety advice, technical information or spare parts, please call our technical support department on 01923 249911, or visit www.trend-uk.com.

SAFETY



WARNING:

Observe the safety regulations in the instruction manual of the power tool to be used. Please read the following instructions carefully. Failure to do so could lead to serious injury. When using electric tools, basic safety precautions, including the following should always be followed to reduce the risk of fire, electric shock and personal injury. Also observe any applicable additional safety rules. Read the following safety instructions before attempting to operate this product.

PLEASE KEEP THESE INSTRUCTIONS IN A SAFE PLACE.

The attention of UK users is drawn to The Provision and Use of Work Equipment Regulations 1998, and any subsequent amendments.

Users should also read the HSE/HSC Safe Use of Woodworking Machinery Approved Code of Practice and Guidance Document and any amendments.

Users must be competent with woodworking equipment before using our products.

IMPORTANT NOTE:

Residual Risk. Although the safety instructions and operating manuals for our tools contain extensive instructions on safe working with power tools, every power tool involves a certain residual risk which cannot be completely excluded by safety mechanisms. Power tools must therefore always be operated with caution!

General

1. Disconnect power tool and attachment from power supply when not in use, before servicing, when making adjustments and when changing accessories such as cutters. Ensure switch is in "off" position. Always ensure cutter has stopped rotating.
2. Always mount the power tool, accessory or attachment in conformity with the instructions. Only use attachment and accessories specified in the power tool manual. The tool or attachment should not be modified or used for any application other than that for which it was designed. Do not force tool.
3. Keep children and visitors away. Do not let children or visitors touch the tool, accessory or attachment. Keep children and visitors away from work area. Make the workshop child proof with padlock and master switch.
4. Dress properly. Do not wear loose clothing or jewelry, they can be caught in moving parts. Rubber gloves and non-skid footwear is recommended when working

outdoors. Wear protective hair covering to contain long hair.

5. Consider working environment. Do not use the product in the rain or in a damp environment. Keep work area well lit. Do not use power tools near gasoline or flammable liquids. Keep workshop at a comfortable temperature so your hands are not cold. Connect machines that are used in the open via a residual current device (RCD) with an actuation current of 30 mA maximum. Use only extension cables that are approved for outdoor use.
6. The accessory or attachment must be kept level and stable at all times.
7. Keep work area clean. Cluttered workshops and benches can cause injuries. Ensure there is sufficient room to work safely.
8. Secure idle tools. When not in use, tools should be stored in a dry and high or locked up place, out of reach of children.
9. For best control and safety use both hands on the power tool and attachment. Keep both hands away from cutting area. Always wait for the spindle and cutter to stop rotating before making any adjustments.
10. Always keep guards in place and in good working order.
11. Remove any nails, staples and other metal parts from the workpiece.
12. Maintain tools and cutters with care. Keep cutters sharp and clean for better and safer performance. Do not use damaged cutters. Follow instructions for lubricating and changing accessories. Keep handles dry, clean and free from oil and grease.
13. Maintain accessories. Do not use damaged accessories. Only use accessories recommended by the manufacturer.
14. Check damaged parts. Before operation inspect the attachment, the power tool, the cable, extension cable and the plug carefully for signs of damage. Check for alignment of moving parts, binding, breakage, mounting and any other conditions that may effect its operation. Have any damage repaired by an Authorised Service Agent before using the tool or accessory. Protect tools from impact and shock.
15. Do not use tool if switch does not turn it on or off. Have defective switches replaced by an Authorised Service Agent
16. Don't over reach. Keep proper footing and balance at all times. Do not use

awkward or uncomfortable hand positions.

17. Don't abuse the cable. Never carry power tool or accessory by cord or pull it to disconnect from the socket. Keep cord from heat, oil and sharp edges. Always trail the power cord away from the work area.
18. Connect dust extraction equipment. If devices are provided for the connection of dust extraction and collection facilities, ensure these are connected and properly used.
19. Check all fixing and fastening nuts, bolts and screws on power tool, attachment and cutting tools before use to ensure they are tight and secure. Periodically check when machining over long periods.
20. Stay alert. Watch what you are doing. Use common sense. Do not operate tools when you are tired, under the influence of drugs or alcohol.
21. Personal Protective Equipment (PPE) for eye, ear and respiratory protection must be worn. All PPE must meet current UK and EU legislation.
22. Do not leave tools running unattended. Do not leave tool until it comes to a complete stop.
23. Always clamp workpiece being machined securely.
24. Only use cutting tools for woodworking that meet EN847-1/2 safety standards, and any subsequent amendments.
25. Vibration levels. Hand held power tools produce different vibration levels. You should always refer to the specifications and relevant Health & Safety Guide.

Routing Safety

1. Read and understand instructions supplied with power tool, attachment and cutter.
2. Keep hands, hair and clothing clear of the cutter.
3. Remove adjusting keys and spanners. Check to see that keys and adjusting spanners are removed from the router tool, cutter and attachment before turning router on. Make sure cutter can rotate freely.
4. Noise. Take appropriate measures for the protection of hearing if the sound pressure of 85dB(A) is exceeded. Routing sound pressure may exceed 85dB(A), so ear protection must be worn.
5. Eye protection. Always wear eye protection in the form of safety goggles, spectacles or visors to protect the eyes.

6. Respiratory protection. Wear a face or dust mask, or powered respirator. Dust masks/filters should be changed regularly.
7. Do not switch router on with the cutter touching the workpiece. At the end of the cut, release the router plunge and allow spindle to stop rotating. Never use the spindle lock as a brake
8. The direction of routing must always be opposite to the cutter's direction of rotation. Do not back-cut or climb-cut.
9. Check before cutting that there are no obstructions in the path of the router. Ensure there are no obstacles beneath workpiece when cutting full thickness, and that a sacrificial work surface is used.

Router Cutter Safety

1. Cutting tools are sharp. Care should be taken when handling them. Do not drop cutters or knock them against hard objects. Handle very small diameter cutters with extra care. Always return cutter to its packaging after use.
2. Always use cutters with a shank diameter corresponding to the size of the collet installed in your tool.
3. The maximum speed (n.max) marked on the tool, or in instructions or on packaging shall not be exceeded. Where stated the speed range shall be adhered to. Recommended speeds are shown in the Trend Routing Catalogue and/or website.
4. Always use router cutters in a router. Drill and boring bits must not be used in a router. Router cutters must only be used for the material cutting application for which they are designed. Do not use on metal or masonry.
5. Never use cutters with a diameter exceeding the maximum diameter indicated in the technical data of the powertool or attachment used.
6. Before each use check that the cutting tool is sharp and free from damage. Do not use the cutting tool if it is dull, broken or cracked or if in any other damage is noticeable or suspected.
7. Cutters should be kept clean. Resin build up should be removed at regular intervals with Resin Cleaner[®]. The use of a PTFE dry lubricant will reduce resin build up. Do not use PTFE spray on plastic parts.
8. When using stacked tooling (multi-blade, block and groover etc.) on a spindle arbor, ensure that the cutting edges are staggered to each other to reduce the cutting impact.
9. Cutter shanks should be inserted into the collet all the way to the line

indicated on the shank. This ensures that at least $\frac{3}{4}$ of the shank length is held in the collet. Ensure clamping surfaces are cleaned to remove dirt, grease, oil and water.

10. Observe the correct assembly and fitting instructions in the router instruction manual for fitting the collet, nut and cutter.
11. Tool and tool bodies shall be clamped in such a way that they will not become loose during operation. Care shall be taken when mounting cutting tools to ensure that the clamping is by the shank of the cutting tool and that the cutting edges are not in contact with each other or with the clamping elements.
12. It is advisable to periodically check the collet and collet nut. A damaged, worn or distorted collet and nut can cause vibration and shank damage. Do not over-tighten the collet nut
13. Do not take deep cuts in one pass; take several shallow or light passes to reduce the side load applied to the cutter and router. Too deep a cut in one pass can stall the router.
15. In case of excessive vibrations whilst using the router stop immediately and have the eccentricity of the router, router cutter and clamping system checked by competent personnel
15. All fastening screws and nuts should be tightened using the appropriate spanner or key and to the torque value provided by the manufacturer.
16. Extension of the spanner or tightening using hammer blows shall not be permitted.
17. Clamping screws shall be tightened according to instructions provided by the manufacture. Where instructions are not provided, clamping screws shall be tightened in sequence from the centre outwards.

Using Routers In A Fixed Position

1. Attention should be made to the HSE's Safe Use of Vertical Spindle Moulding Machines Information Sheet No.18 and any revisions.
2. After work, release the router plunge to protect the cutter.
3. Always use a push-stick or push-block when making any cut less than 300mm in length or when feeding the last 300mm of the cut.
4. The opening around the cutter should be reduced to a minimum using suitably sized insert rings in the table and closing the back fence cheeks or fitting a false fence on the back fence.
5. Whenever possible use a work holding device or jig to secure

component being machined. Ensure any attachment is securely fitted to the workbench, with table surface at approximately hip height.

6. Use a No-Volt Release Switch. Ensure it is fixed securely, easily accessible and used correctly.
7. In router table (inverted) mode, stand to the front right of the table. The cutter will rotate anti-clockwise when viewed from top so the feed direction is from the right (against the rotation of the cutter). In overhead mode, stand to the front left of the machine table and the feed direction is from the left.
8. Do not reach underneath table or put your hands or fingers at any time in the cutting path while tool is connected to a power supply.
9. Never thickness timber between the back of the cutter and the backfence.

Useful Advice When Routing

1. Judge your feed rate by the sound of the motor. Feed the router at a constant feed rate. Too slow a feed rate will result in burning.
2. Trial cuts should be made on waste material before starting any project.
3. When using some attachments e.g. a router table or dovetail jig, a fine height adjuster is recommended.
4. When using a template guide bush, ensure there is sufficient clearance between cutter tip and inside edge of bush and that it cannot come into contact with collet and nut. Ensure cutter and guide bush are concentric.

Router Cutter Repair/Maintenance

1. Repair of tools is only allowed in accordance with the manufacturers instructions.
3. The design of composite (tipped) tools shall not be changed in process of repair. Composite tools shall be repaired by a competent person i.e. a person of training and experience, who has knowledge of the design requirements and understands the levels of safety to be achieved.
4. Repair shall therefore include, e.g. the use of spare parts which are in accordance with the specification of the original parts provided by the manufacturer.
5. Tolerances which ensure correct clamping shall be maintained.
6. Care shall be taken that regrinding of the cutting edge will not cause weakening of the body and the connection of the cutting edge to the body.

Version 7.1 06/2006

ELECTRICAL SAFETY 

Power Supply



Before any maintenance work, isolate mains plug from power source.

The electric motor has been designed for one voltage only. Always check that the power supply corresponds to the voltage on the rating plate. Machines marked for 230 volt can also be operated from a 220 volt supply.



The vacuum cleaner is supplied from the factory with mains supply cable which has an earthed plug. It must only be connected to an approved earthed socket.

Mains Plug Replacement (UK & Ireland only)

Always check the condition of the cable and plug before starting with your work. Should your mains plug need replacing and you are competent to do this, proceed as instructed below. If you are in doubt, contact an authorised Trend Repair Agent or a qualified electrician.

- Disconnect the plug from the supply.
- Cut off the plug and dispose of it safely; a plug with bared copper conductors is dangerous if engaged in a live socket outlet.
- Only fit 13 Amperes BS 1363A approved plugs fitted with a 13 Amp A.S.T.A approved BS 1362 fuse (1).
- The cable wire colours, or a letter, will be marked at the connection points of most good quality plugs. Attach the wires to their respective points in the plug (see below left). Brown is for Live (L) (2), Blue is for Neutral (N) (3) and Green/Yellow is for earth \perp (4).

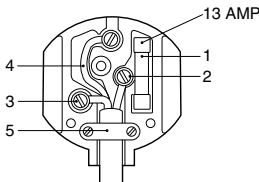

- Before replacing the top cover of the mains plug ensure that the cable restraint (5) is holding the outer sheath of the cable firmly and that the two leads are correctly fixed at the terminal screws.

For 115V units with a power exceeding 1500W, we recommend to fit a plug to BS4343 standard.



Never use a light socket. Never connect the live (L) or neutral (N) wires to the earth pin marked E or \perp .

Using an Extension Cable

- If an extension cable is required, use an approved triple core extension cable suitable for the power input of this tool (see technical data). The minimal conductor size is 1.5mm².
- When using a cable reel, always unwind the cable completely.
- Also refer to the tables below.

Conductor size (mm ²)	Cable rating (Amperes)
0.75	6
1.00	10
1.50	15
2.50	20
4.00	25

Voltage	Amperes	Cable length (m)					
		7.5	15	25	30	45	60
115	0 - 2.0	6	6	6	6	6	10
	2.1 - 3.4	6	6	6	6	15	15
	3.5 - 5.0	6	6	10	15	20	20
	5.1 - 7.0	10	10	15	20	20	25
	7.1 - 12.0	15	15	20	25	25	-
	12.1 - 20.0	20	20	25	-	-	-
230	0 - 2.0	6	6	6	6	6	6
	2.1 - 3.4	6	6	6	6	6	6
	3.5 - 5.0	6	6	6	6	10	15
	5.1 - 7.0	10	10	10	10	15	15
	7.1 - 12.0	15	15	15	15	20	20
	12.1 - 20.0	20	20	20	20	25	-

VACUUM CLEANING SAFETY

General Safety



Fire and explosion hazard.

- Never vacuum-clean inflammable fluids, such as gas, oil, alcohol, solvents, etc. Do not work near inflammable fluids or gas. Never vacuum-clean warm fluids or material at more than 60°C, such as burning cigarettes, ashes, glowing coals, etc.



Do not vacuum hazardous substances.

- Do not pull the cable and do not damage the insulation of the cable. When faulty, the cable must be replaced immediately.
- Always keep the cartridge filter clean.



Fire and explosion hazard.

Do Not Vacuum:



- Hot materials (glowing cigarettes, hot ashes, etc.)
- Inflammable, explosive or aggressive fluids (e.g. petrol, solvents, acids, alkalines, etc.)
- Inflammable, explosive dusts (e.g. magnesium or aluminium dust, etc.).
- Always trail the cable away from the working area.

General Safety Regulations when Routing

Noise

The level of noise when routing may exceed 85 dB(A). It is therefore advisable to wear ear defenders especially if routing for long periods of time.

Eye Protection

Goggles, safety spectacles or visors should be worn to protect the eyes from ejected waste particles.

Dust Protection

The fine dust created when routing presents a severe health risk if it is inhaled. Always wear a dust protection mask or respirator and use the dust spout connected to the T30A/T30AF extractor. Dust masks should be changed regularly.

**MANUFACTURERS
DECLARATION**



We declare under our sole responsibility that this product is in conformity with the following standards of standardised documents:

EN 60335.1, EN 60335.2.2, EN 50081.1, EN 50082.1, EN 55014.1, EN 55014.2, EN 61000.3.2, EN 61000.3.3 in accordance with the directives 98/37/EC, 73/23/EEC, 93/68/EEC, 89/336/EEC.



We declare under our sole responsibility that this product is in conformity with the following standards of standardised documents:

EN 60335.1, EN 60335.2.2, EN 50081.1, EN 50082.1, EN55014.1, EN 55014.2, EN61000.3.2, EN61000.3.3, EN 61000.4.2, EN 61000.4.4, EN 61000.4.5, EN 61000.4.6, EN 61000.4.11 in accordance with the directives 98/37/EC, 73/23/EEC, 93/68/EEC, 89/336/EEC.

**INFORMATION ON
NOISE/VIBRATION**



The noise level when working can exceed 85 dB(A).

Wear ear protection!

Managing Director
Jeff Willcocks

Trend Machinery & Cutting Tools Ltd.

ITEMS ENCLOSED

- 1 x Cartridge Filter (12 micron for T30A)
(0.3 micron for T30AF & T30ALF)
- 5 x Castors
- 1 x Paper Filter Bag
- 1 x Hose 5m x 36mm Ø with Spout
- 2 x Extension Tubes
- 1 x Universal Spout
- 1 x Spout for Carpets
- 1 x Spout for Floors
- 1 x Spout for Fluids
- 1 x Power Tool Adaptor
- 1 x Crevice Tool
- 1 x Upholstery Tool
- 1 x Manual
- 1 x Guarantee Card

Also for the T30AF & T30ALF

- 1 x Nylon Pre-Filter

For extraction of fine dust particles the 0.3 micron cartridge filter must be used with the nylon pre-filter and paper filter bag.

CARTRIDGE FILTER COLOURS			
Filter Size	Outer Colour	Inner Colour	Mesh
12 Micron	Yellow	Yellow	Diamond
0.3 Micron	Yellow	White	Round



**110v unit accepts tools up to
1000 watts only.**

DESCRIPTION OF PARTS

- ① Switch ON-OFF
- ② Socket for auto-start
230V max. 2000 W safe load
110V max. 1000 W safe load

- ③ Switch AUTOMATIC:
Position M: vacuum cleaner running
Position A: vacuum cleaner automatically starts when the accessories attached to plug are activated.

- ④ Carrying handle
- ⑤ Motor filter
- ⑥ Float
- ⑦ Cartridge filter
-for T30A & T30/EURO (12 micron)
-for T30AF & T30ALF (0.3 micron)

- ⑧ Paper-filter bag
- ⑨ Container
- ⑩ Cartridge filter cap
- ⑪ Container catch
- ⑫ Bumper
- ⑬ Castors
- ⑭ Hose release button
- ⑮ Cloth filter (optional) - for T30AF & T30ALF
nylon pre-filter is supplied as standard

- ⑯ Hose 5m x 36mmØ
- ⑰ Extension tubes
- ⑱ Universal spout: a) for carpets
b) for floors
c) for fluids

- ⑲ Crevice tool
- ⑳ Upholstery tool
- ㉑ Power tool adaptor

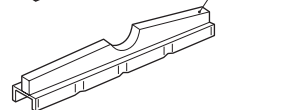
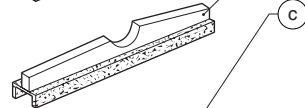
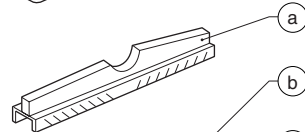
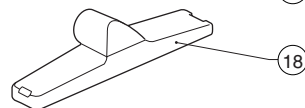
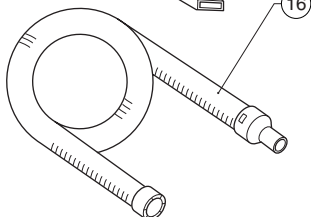
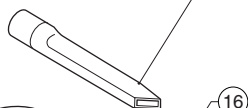
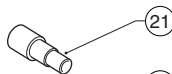
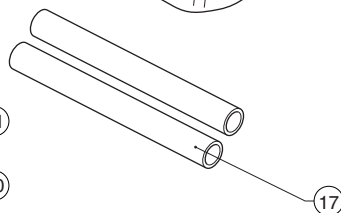
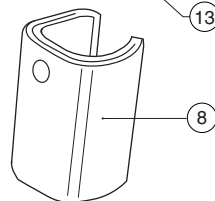
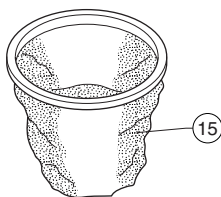
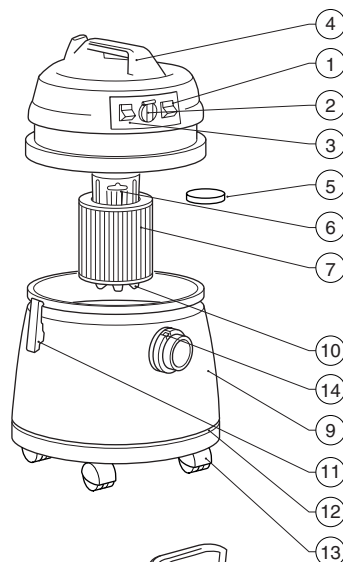

ASSEMBLY 



Some of the accessories are supplied inside the container and so must be removed before using the unit.

- Insert the five castor wheels in their purposely provided housings under the container (9).
- Connect the hose to container (9). To remove it, push button (14) and pull the hose towards you.
- The connection of the extension tubes and of its accessories is carried out by exerting a small amount of pressure. To remove them, turn the parts in the opposite direction and draw them apart.
- To use the universal spout (18), follow these instructions for:
 - Carpet - without bristles (18a)
 - Floor - with bristles (18b)
 - Fluids - with rubber strip (18c)

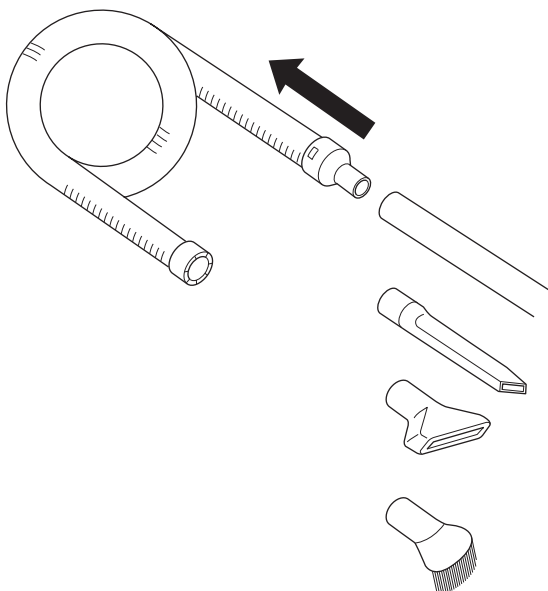
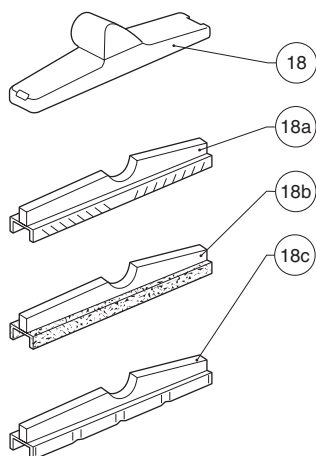
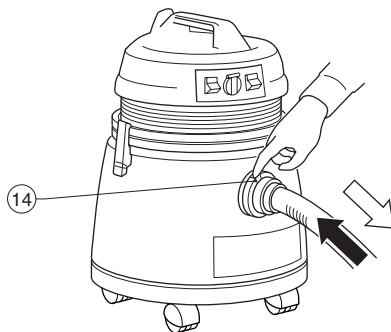
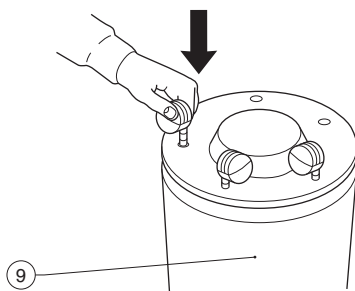

OPERATION



Suction of Dry Dust and Dirt



- The filter cartridge (7) has to be completely pushed in and is secured by turning the filter cartridge cap (10). Check that it fits correctly.
- In order to remove the cartridge filter (7) turn the cap (10) anti-clockwise and draw the cartridge filter. Fix the paper-filter bag (8) to the inner side of the tube-connection in the container, ensuring it is fully seated. When using the paper-filter bag the dirt can be removed more hygienically and the life-endurance of the cartridge filter will be extended. The paper-filter bag (8) should never replace the cartridge filter, however the 12 micron cartridge filter can be used without the paper-filter bag. The 0.3 micron cartridge filter should always be used with a paper filter bag.



If suction pressure decreases, replace the paper-filter bag with a new one. From time to time the cartridge filter (7) should be cleaned with a soft brush, ensuring longer life and at the same time higher performance.



When vacuum cleaning dry material, always use a cartridge filter, otherwise it could damage the motor.

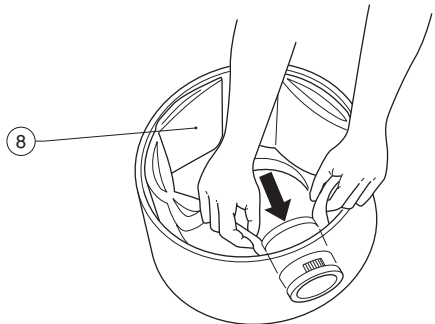
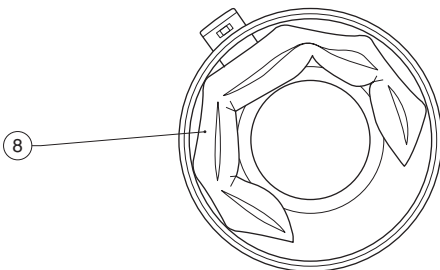
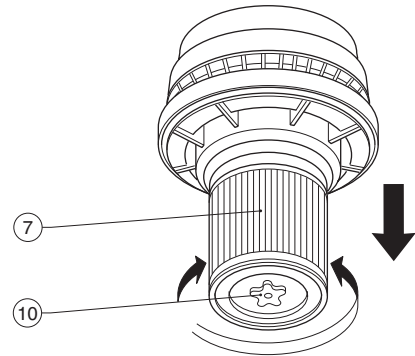
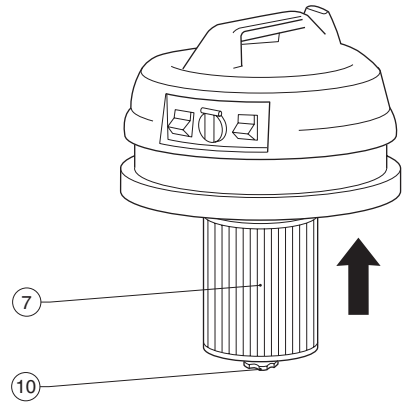

Suction of Fluids



Before picking up fluids, do not forget to:

- empty container (9)
- remove paper-filter bag (8)
- remove cartridge filter (7)

Should the cartridge filter not be removed by mistake this could lead to motor damage. In order to guarantee enough air flow it is recommended not to immerse it completely in the fluids. When the fluids have reached the highest permitted level in the container, the float regulator (6) automatically blocks the suction and the motor pitch will change: switch off the vacuum cleaner IMMEDIATELY, pull out the plug, remove the suction head from the container and empty the container.

MAINTENANCE

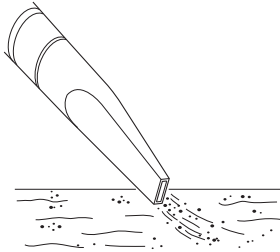

- After every use empty container (dirt, dust and fluids). Never leave fluids in the tank, these could damage the filters and container in the course of time.
- After having picked-up fluids, dry the extension tubes, hose and motor-parts by running the vacuum-cleaner for a few minutes, having emptied the container. Always keep a reserve of paper-filter bags and cartridge filters, so that the vacuum cleaner is always ready for use.



Before plugging in your extractor, make sure that the power switch of your power tool has been TURNED OFF to avoid its accidental starting. Remember the power tool socket is always live when your extractor is plugged in.

T30

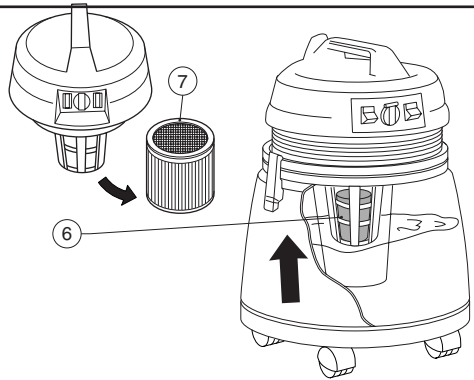

ENVIRONMENTAL PROTECTION



Recycle raw materials instead of disposing as waste.

Accessories and packaging should be sorted for environmental-friendly recycling.



Separate collection. This product must not be disposed of with normal household waste.

Household User

Local regulations may provide for separate collection of electrical products from the household, at municipal waste sites or by retailer when you purchase a new product.

Please call Trend Technical Support for advice as to how to dispose of unwanted Trend electrical product in an environmentally safe way or visit www.trend-uk.com

Business User

Please call Trend Customer services for disposal of unwanted Trend electrical products.

Local regulations may provide for separate collection of electrical products from the household, at municipal waste sites or by retailer when you purchase a new product.

Please call Customer Services for advice as to how to dispose of unwanted Trend electrical product in an environmentally safe way.

GUARANTEE

The machine carries a manufacturers guarantee in accordance with the conditions on the enclosed guarantee card.

For the location of your nearest Trend Service Agent, please call Customer Services or see Stockist Locator at www.trend-uk.com.

T30 - SPARE PARTS LIST			v4.0 04/2010
No.	Qty.	Desc.	Ref.
1	1	Container Housing	WP-T30/001
2	1	Motor Cover	WP-T30/002
3	1	Motor Housing	WP-T30/003
4	2	Container Clip	WP-T30/004
5	5	Castor	WP-T30/005
6	1	3 Core Cable with Plug 230V UK	WP-T30/006
	1	2 Core Cable with Plug 230V EURO	WP-T30EUR/006
	1	3 Core Cable with Plug 110V UK	WP-T30L/006
7	1	Cable Clip	WP-T30/007
8	1	Washer 5.2mm x 11mm x 1.0mm	WP-T30/008
9	1	Screw Self Tapping Pan 4.8mm x 19mm Pozi	WP-T30/009
10	1	Circuit Board with Leads 230V UK & EURO	WP-T30A/010
	1	Circuit Board with Leads 110V UK	WP-T30AL/010
11	1	Lead Earth (yellow/green x 115mm)	WP-T30A/011
12	15	Screw Self Tapping Pan 3.5mm x 19mm Pozi	WP-T30/012
13	1	Cable Block UK	WP-T30/013
	1	Cable Block EURO	WP-T30EUR/013
14	1	Circuit Board Band	WP-T30/014
15	1	Switch Cover Plate 230V UK	WP-T30A/015
	1	Switch Cover Plate 230V EURO & 110V UK	WP-T30EUR/015
16	-	-	-
17	1	Auto Start Socket 230V UK Plug & Cover	WP-T30A/017
	1	Auto Start Socket & Plate 230V EURO Plug & Cover	WP-T30EUR/017
	1	Auto Start Socket & Plate 110V UK Plug	WP-T30AL/017
18	7	Screw Self Tapping Csk 3.5mm x 17mm Pozi	WP-T30/018
19	1	Switch Autostart AM 230V UK	WP-T30A/019
	1	Switch Autostart AM 230V EURO	WP-T30EUR/019
	1	Switch Autostart AM 110V UK	WP-T30AL/019
20	1	Switch On-Off 230V UK & EURO	WP-T30/020
	1	Switch On-Off 110V UK	WP-T30L/020
21	1	Rubber Bumper	WP-T30/021
22	1	Foam Baffle Set Upper Housing	WP-T30/022
23	1	Rubber Seal Set	WP-T30/023
24	1	Rubber Grommet Plug	WP-T30/024
25	4	Push-on Fastner 5mm Shaft	WP-T30/025
26	1	Foam Baffle for Switch	WP-T30/026
27	1	Neoprene Seal	WP-T30/027
28	1	Foam Filter for Motor	WP-T30/028
29	1	Rubber Seal for Motor Small	WP-T30/029
30	1	Rubber Gasket for Housing/Motor	WP-T30/030
31	1	Motor Assembly c/w Leads 230V	WP-T30/031
	1	Motor Assembly c/w Leads 110V UK	WP-T30L/031
32	1	Carbon Brush 230V (1 pair)	WP-T30/032
	1	Carbon Brush 110V (1 pair) UK	WP-T30L/032
33	1	Rubber Gasket for Motor Large	WP-T30/033

T30 - SPARE PARTS LIST			v4.0 04/2010
No.	Qty.	Desc.	Ref.
34	1	Lower Motor Housing	WP-T30/034
35	1	Foam Baffle Lower Housing	WP-T30/035
36	1	Rubber Grummet External	WP-T30/036
37	1	Float	WP-T30/037
38	1	Float Cage	WP-T30/038
40	1	Cartridge Filter 12 Micron (T30A)	T30/6
	1	Cartridge Filter 0.3 Micron (T30AF & T30ALF)	T30/5
41	1	Cartridge Filter Cap Plate	WP-T30/041
42	1	Cartridge Filter Cap	WP-T30/042
43	1	Container Hose Bayonet Fitting	WP-T30/043
44	1	Paper Filter Bag	T30/1
45	1	Hose Adaptor 36mm	WP-T30/045
46	1	Hose Bayonet 36mm	WP-T30/046
47	1	Hose Adaptor Fitting	WP-T30/047
48	2	Hose Adaptor Clip	WP-T30/048
49	1	Hose Only 5m x 36mm	WP-T30/049
50	0	Hose 36mm x 5m c/w Fittings	WP-T30/050
51	2	Extension Tube	WP-T30/051
52	1	Universal Spout	WP-T30/052
53	1	Universal Brush for Carpets	WP-T30/053
54	1	Universal Brush for Floors	WP-T30/054
55	1	Universal Brush for Fluids	WP-T30/055
56	1	Power Tool Adaptor 36mm Hose	WP-T30/056
57	1	Upholstery Tool 36mm Hose	WP-T30/057
58	1	Crevice Tool 36mm Hose	WP-T30/058
59	0	Nylon Pre-filter (Supplied as standard with T30AF & T30ALF)	T30/3
60	1	Manual	MANU/T30

ACCESSORIES

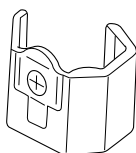

Replacement paper filter bag.

Ref. T30/1 1 off
T30/15 5 off
T30/10 10 off



Nylon pre-filter for fine dust and wet & dry use. Use with 0.3 micron cartridge filter.

Ref. T30/3

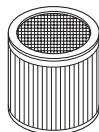

0.3 micron cartridge filter for fine dust. Use with nylon pre-filter.

Ref. T30/5



12 micron replacement cartridge filter.

Ref. T30/6



No foam filter to prevent foaming when used for wet use.

Ref. T30/4



Cloth pre-filter for normal/dry use. Ideal for use with 12 micron cartridge filter.

Ref. T30/2



Furniture brush

Ref. T30/20

Hose adaptor joint 57/58mm to 36mm.

Ref. T30/21

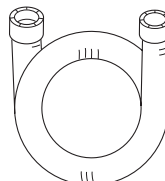

Hose 58mm x 1.5m.

Ref. T30/22

T30 - SPARE PARTS DIAGRAM

v4.0 07/2010

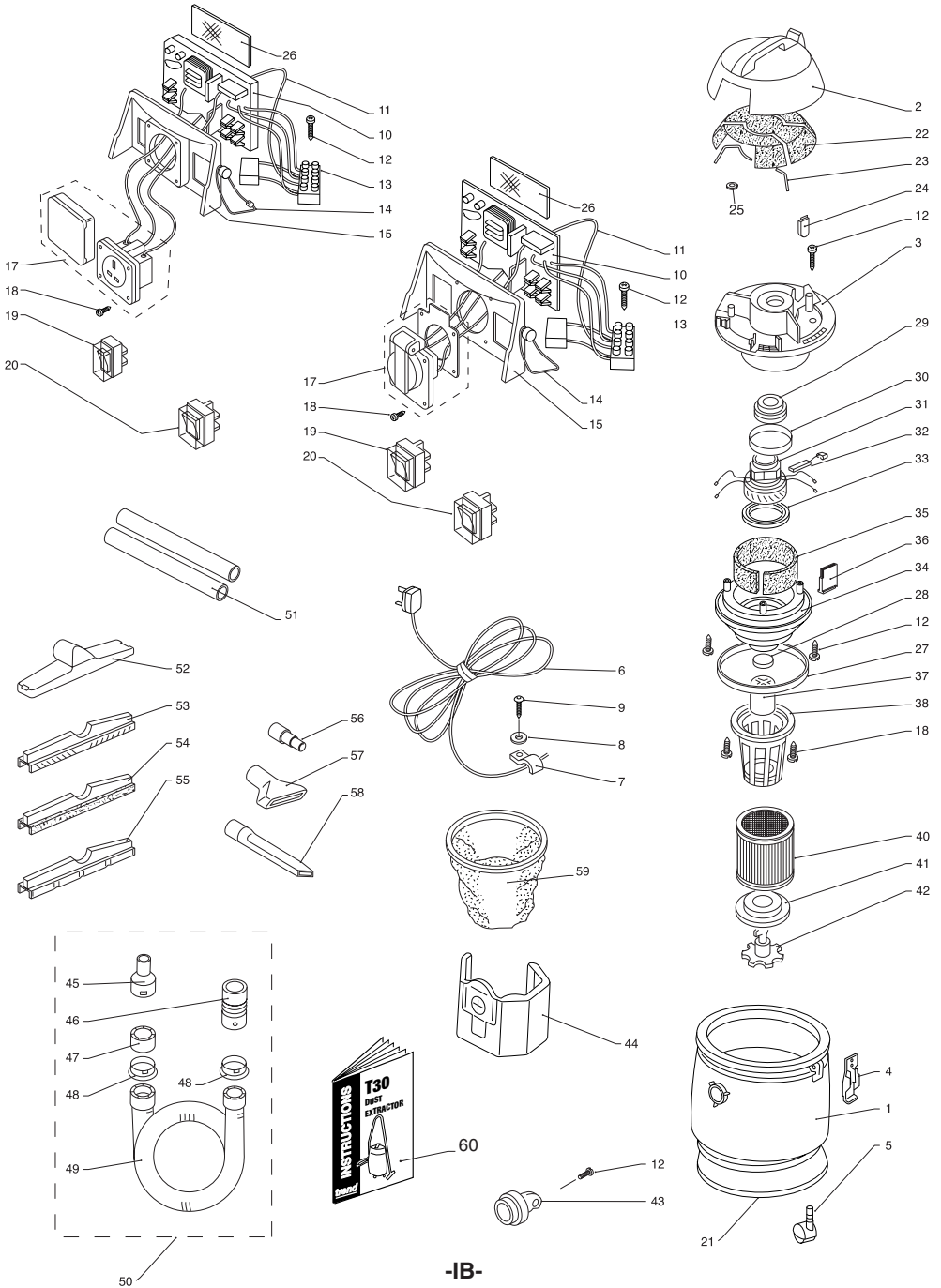

MANU/T30 v8.0



RECYCLABLE

Trend Machinery & Cutting Tools Ltd.

Odhams Trading Estate St Albans Road
Watford WD24 7TR England

Telephone: _____ 0044 (0) 1923 249911

Email: _____ enquiry@trendm.co.uk

Web: _____ www.trend-uk.com